

Route 57

Updated: November 2011

Orangeville Junction on 29 via Orangeville to Route 10. March 7, 1927.

1953 Description:

From Orangeville Junction on Route 29 southerly via Orangeville to Route 10.

1963 Description:

This route was reversed and **approved by Legislature.**

From Route 10 northerly via Orangeville to Orangeville Junction on Route 29.

Approved by 1963 Legislature:

Approved by 1965 Legislature:

1967 Legislature:

*(A) *(B)

1983 Description:

From Route 10 northerly to the Wilberg Mine northwest of Orangeville, **approved by 1983 Legislature**, effective May 10, 1983.

1985 Legislature: Description remains the same.

1986 Legislature: Description remains the same.

1987 Legislature: Description remains the same.

1988 Legislature: Description remains the same.

1990 Legislature: Description remains the same.

1992 Legislature: Description remains the same.

1993 Legislature: Description remains the same.

1994 Legislature: Description remains the same.

1995 Legislature: Description remains the same.

1996 Legislature: Description remains the same.

1997 Legislature: Description remains the same.

1998 Legislature: Description remains the same.

1999 Legislature: Description remains the same.

2000 Legislature: Description remains the same.

2001 Legislature: Description remains the same.

2002 Legislature: Description remains the same.

2003 Legislature: Description remains the same.

2004 Legislature: Description remains the same.

2005 Legislature: Description remains the same.

2006 Legislature: Description remains the same.

2007 Legislature: Description remains the same.

2008 Legislature: Description remains the same.

2011 Legislature: Description remains the same.

* Refers to resolution index page following.

Route 57

COUNTY VOLUME & RESOLUTION NO.

A. Emery Co. 6/13

B. Emery Co. 6/39

DESCRIPTION OF RESOLUTION CHANGE

- (A). Relocation/New Alignment - From 2.58 miles north of jct. With SR-10 northerly to jct. With SR-29.
- (B). Extension - From jct. With SR-29 northerly to the Wilberg Mine.

R E S O L U T I O N

Realignment SR-57

Addition CR-482

WHEREAS, the Utah State Legislature granted the request for an appropriation of highway development funds as applied for by Utah Power & Light, to be used on a corridor from the Emery Power Plant to the Peabody Coal Company's Wilberg Mine, and

WHEREAS, Emery County and Orangeville City accepted the results of the study prepared by the Statewide Planning Section as required by the Resource Development Act, and

WHEREAS, the Local Government Liason Section has recommended the placement of the county road from SR-29 to the Wilberg Mine on the Collector Road System, and

WHEREAS, the Statewide Planning Section has functionally classified SR-57 as a Major Collector, and the county road from SR-29 to the Wilberg Mine as a Minor Collector.

NOW THEREFORE, be it resolved that beginning with the intersection of SR-10 and SR-57 and proceeding northerly along the present alignment of SR-57 for a distance of 2.58 miles thence along new alignment bypassing Orangeville City on the west to SR-29, a distance of 3.26 miles, be designated as SR-57, and

Be it further resolved that the remainder of the old SR-57 alignment, from the beginning of the bypass and going through Orangeville City, be transferred, upon completion of the bypass, to the jurisdiction of Emery County, for a distance of 0.50 miles, and Orangeville City, for a distance of 0.95 miles, respectively, and

That Emery County and Orangeville City may not abandon those sections of the road without prior approval of the Utah Department of Transportation and the Federal Highway Administration, and

Be it further resolved that the county road from SR-29 to the entrance of the Wilberg Mine, a distance of 5.20 miles, be placed on the Collector Road System and designated as CR-482, and

Be it further resolved that the SR-57 mileage will increase 1.81 miles for a total mileage of 5.84 miles, and

That Emery County's "B" System mileage will increase 0.50 miles and the Orangeville City "C" System mileage will increase 0.95 miles, and

Be it further resolved that the Collector Road System mileage will increase to 2558.2 miles, and

That the accompanying application and maps be submitted as a part of this resolution.

Dated this 14th day of July, 1978.

UTAH TRANSPORTATION COMMISSION

R. LaJaur Cox
Chairman

Wayne A. Winters
Vice-Chairman

Chris E. Lund
Commissioner

Henry A. Church
Commissioner

James J. Taylor
Commissioner

ATTEST:

Ronald A. Seabury
Secretary

UTAH COLLECTOR ROAD CONSTRUCTION PROGRAM

APPLICATION FOR REVISION - COLLECTOR ROAD SYSTEM

Date May 19, 1978 County Emery City _____

New Addition or Extension of Collector Road No. _____

Alignment: Existing New Length 5.2 miles

Functional uses:

Inter-city Inter-county School bus route

Parks Mining Mail route

Recreation Agriculture Industry

Other _____

Average Daily Traffic: 750 How Determined see below

Additional Justification:

1. UP&L Predicts a loaded coal truck every 6 min.
assuming 2 shifts: 24 coal trucks/hr x 16 hr = 380 / day
2. Present mine employment = 150
150 vehicles x 2 trips = 300 / day
3. Other estimated @ 10% 70

Submitted by *Shirley E. Jones* Title: County Commissioner TOTAL 750

RECOMMENDATIONS

By	Signature	Title	Date Approved	Date Disapproved
Highway Department Staff	<i>[Signature]</i>	L.C.P.E.	6/1/78	
County Road Committee	NA			
City Streets Committee	NA			
State Road Commission				

Distribution: (NCR - No Carbon Required)

White - Local Government Projects Engineer
Pink (2) - Systems Planning Division

Yellow - District Engineer
Blue - Local Government

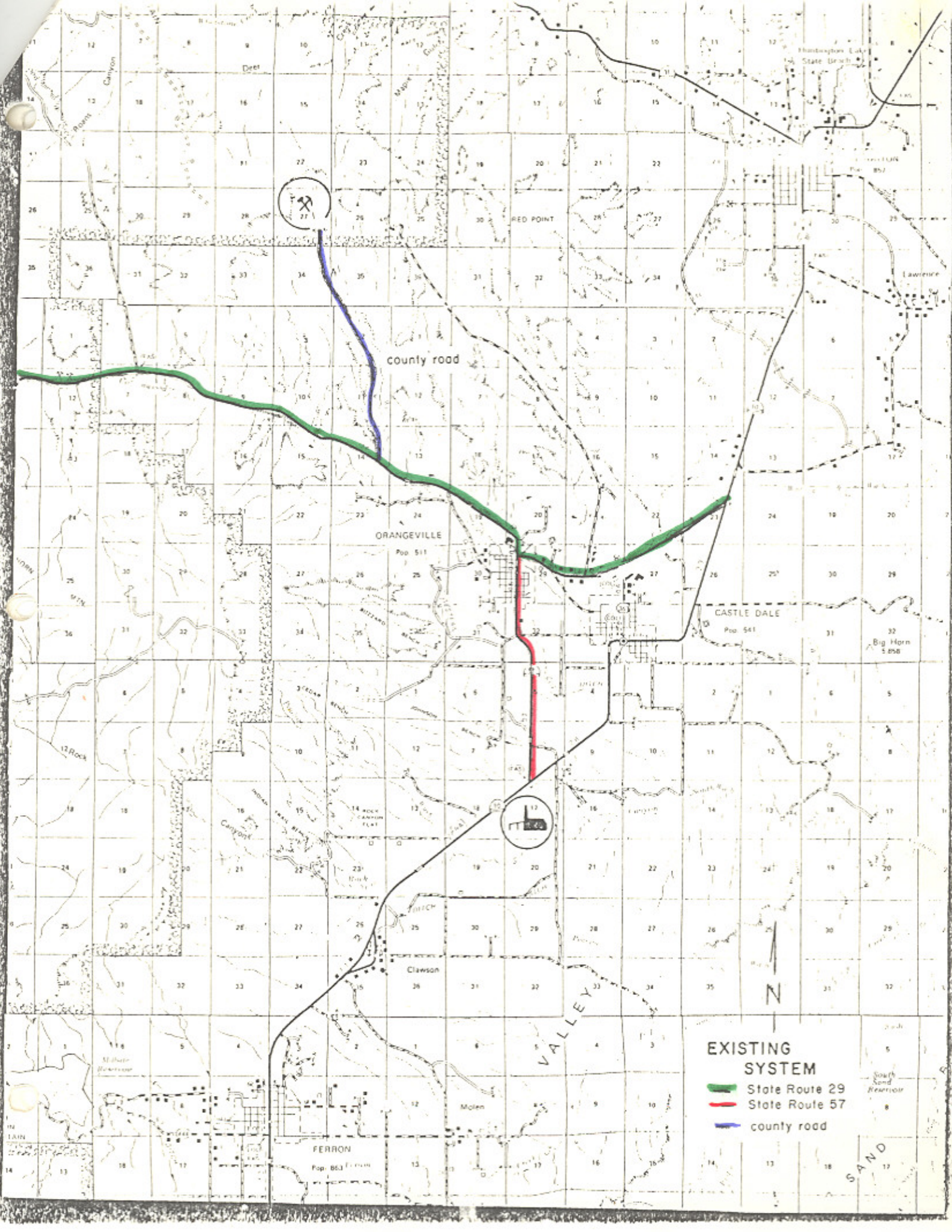

EXISTING SYSTEM

- State Route 29
- State Route 57
- county road

South and Ferris

SAND



county road

ORANGEVILLE

CASTLE DALE

FERRON

VALLEY

N

Humboldt Lake State Branch

Lawrence

Big Horn

Roans Canyon

3rd Cedar Bend

Clawson

Molen

12 Rock

12 Rain

12 Rain

12 Rain

12 Rain

12 Rain

12 Rain

12 Rain

12 Rain

12 Rain

12 Rain

12 Rain

12 Rain

12 Rain

12 Rain

12 Rain

12 Rain

12 Rain

12 Rain

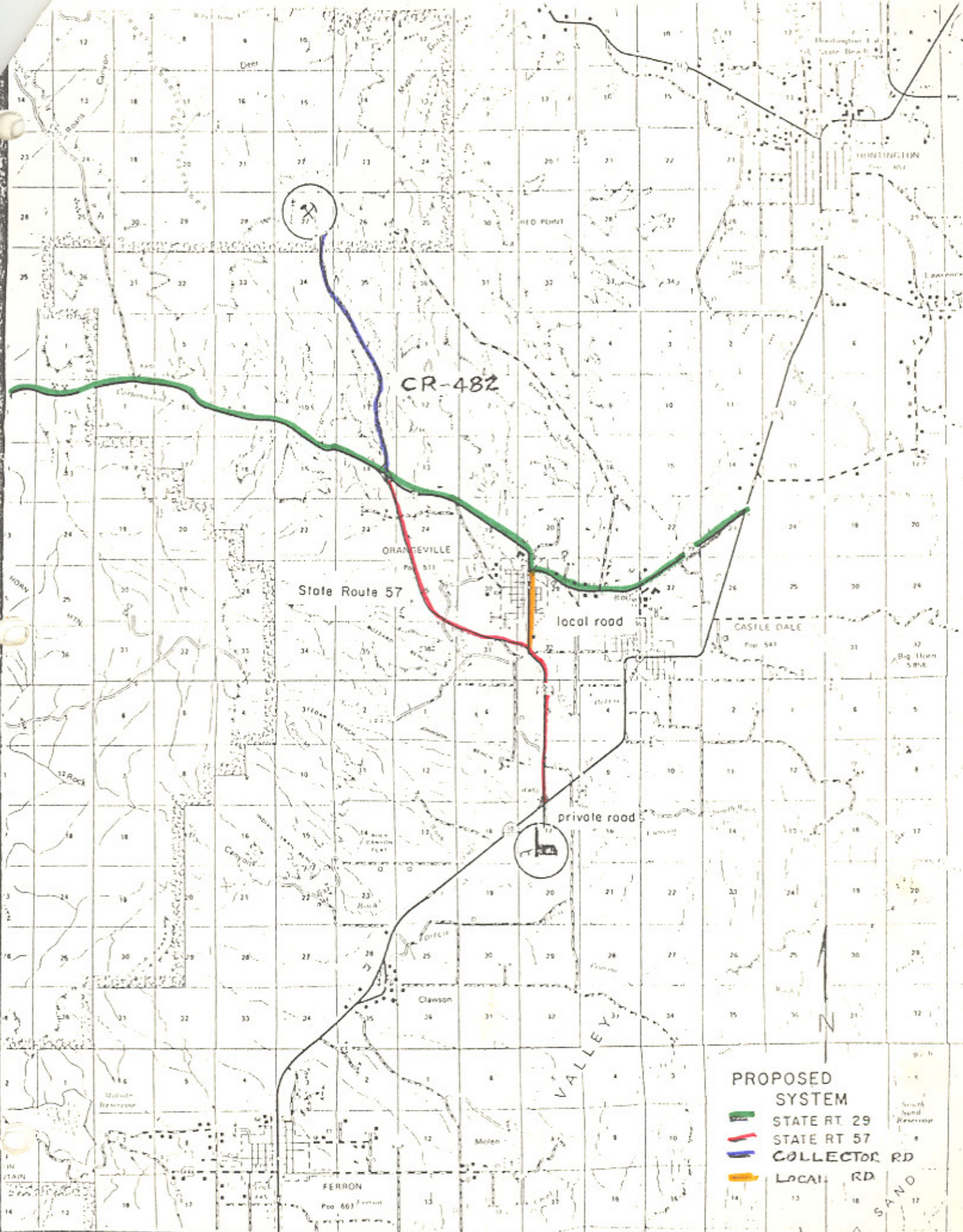

PROPOSED SYSTEM

-  STATE RT 29
-  STATE RT 57
-  COLLECTOR RD
-  LOCAL RD

South Sand River

UTAH STATE DEPARTMENT OF HIGHWAYS

August 18, 1978

C Mr. Cardell Snow, Chairman
Emery County Commission
Emery County Courthouse
Castle Dale, Utah 84513

Dear Commissioner Snow:

O Subject: Realignment of State Route and Addition of Collector Route
in Emery County

Effective July 14, 1978, the Utah Transportation Commission approved the transfer to local jurisdiction that portion of the old alignment of SR-57 created by the new construction of SR-57, and the addition of Route 482 to the Collector System as described in the enclosed resolution.

P Enclosed is a copy of the resolution and location maps.

Very truly yours,

Y L. R. Jester, P.E.
Engineer for Transportation Planning

Enclosure

Same letter sent to: Michael McKay Smith, Mayor of Orangeville City
Sterling Davis, District #4 Director
Howard B. Leatham, Engineer for Planning & Programming

Information sent to:

Jerry Fenn	W. J. Stephenson	Martin Cutler	Charles Bertolina
Ralph Murdock	J. Q. Adair	Ray Behling	E. E. Lovelace
Dennis Spackman	James Naegle	Bonnie Garcia	Don Jensen
Robert Wheadon	Robin Hood	John W. Homer	Clarence Bywater
Keith Rosevear	Art Guerts	Henry Skriner	Ken Riddle

WDM:RDent:bt

RESOLUTION
Addition to State Route 57
Emery County

WHEREAS, Emery County has requested that the roadway from a junction with State Route 29 and 57, northwest of Orangeville in Emery County, northerly to the Wilberg Mine be added to the State System of Highways, and

WHEREAS, to maintain continuity of the State System of Highways it is recommended that this road be an extension of State Route 57.

NOW THEREFORE, be it resolved that the Transportation Commission recommends to the State Legislature that State Route 57 be extended from its present terminus at the junction with State Route 29, northerly to the Wilberg Mine, a distance of 4.37 miles.

That the aforementioned revision to the State System of Highways be submitted to the State Legislature for its approval at the next regular session of the Legislature, and

That by this action the State System of Highways will increase 4.37 miles and Emery Counties "B" Road System will decrease 4.37 miles, and

That the accompanying map be made a part of this submission.

Dated this 15th day of October 1982

UTAH TRANSPORTATION COMMISSION

B. LaSain Cox
Chairman

W. J. H. F.
Vice Chairman

Clayton Church
Commissioner

Charles Clayburgh
Commissioner

Samuel J. ...
Commissioner

ATTEST:

Irene A. Anderson

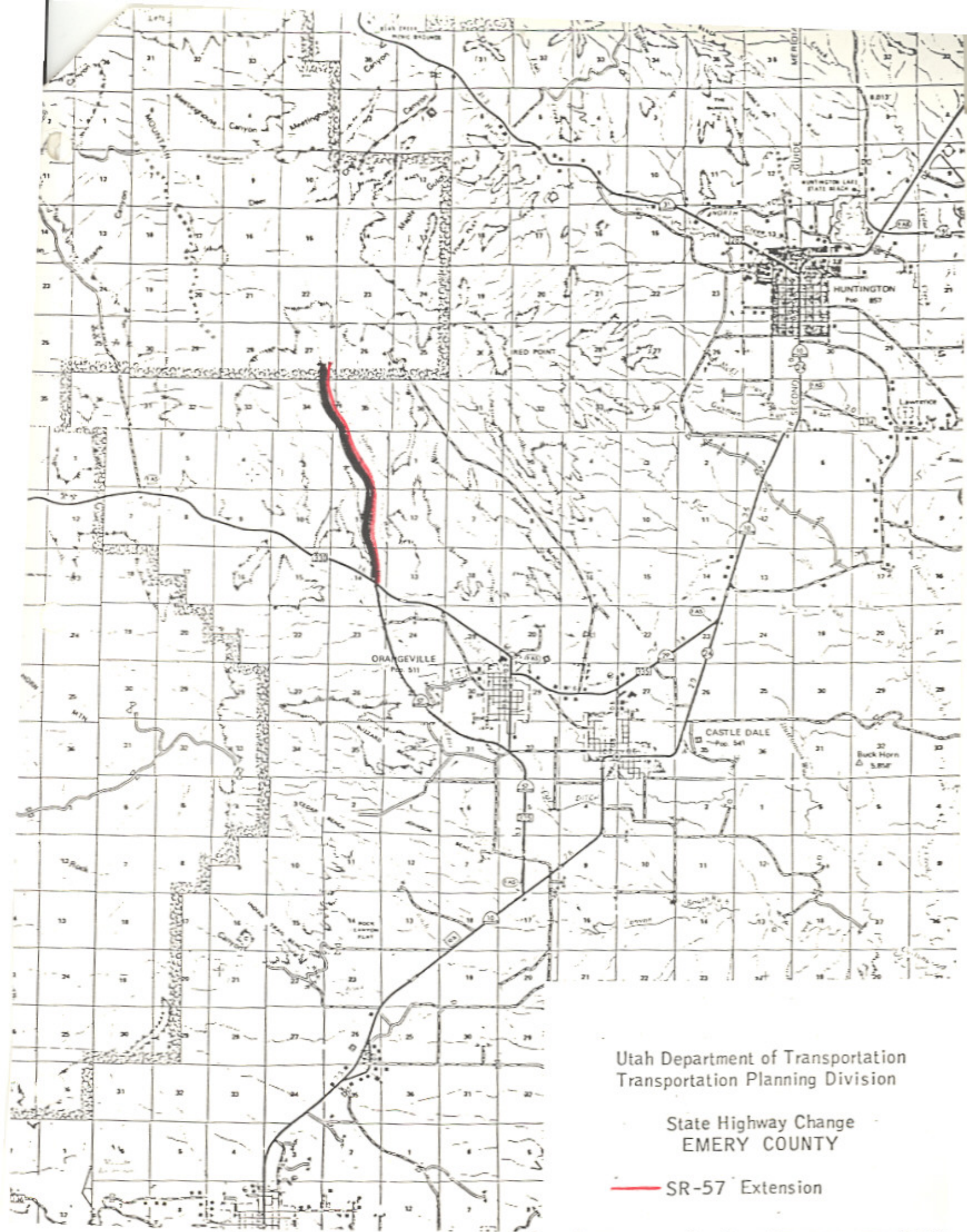

Utah Department of Transportation
Transportation Planning Division

State Highway Change
EMERY COUNTY

— SR-57 Extension